

Internal Fixing & Roof Membrane Option A

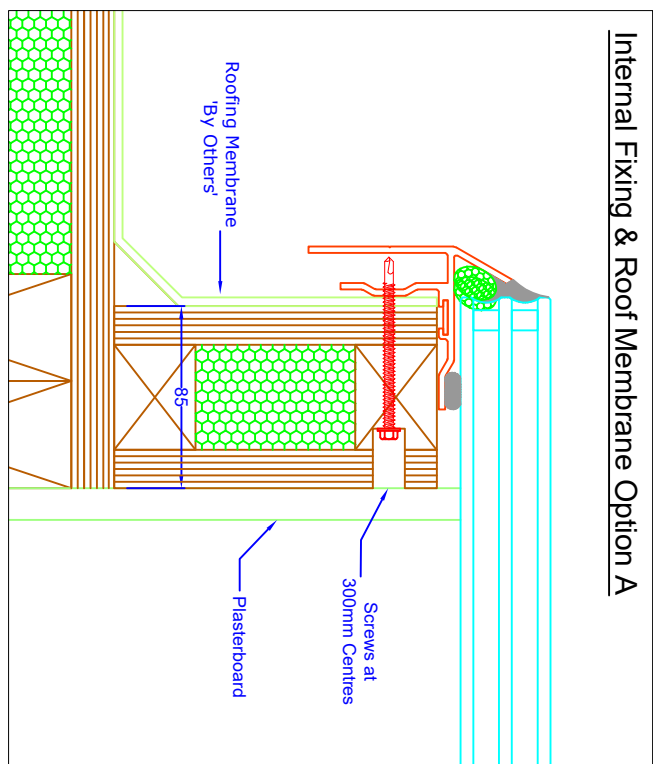

External Fixing & Roof Membrane Option B

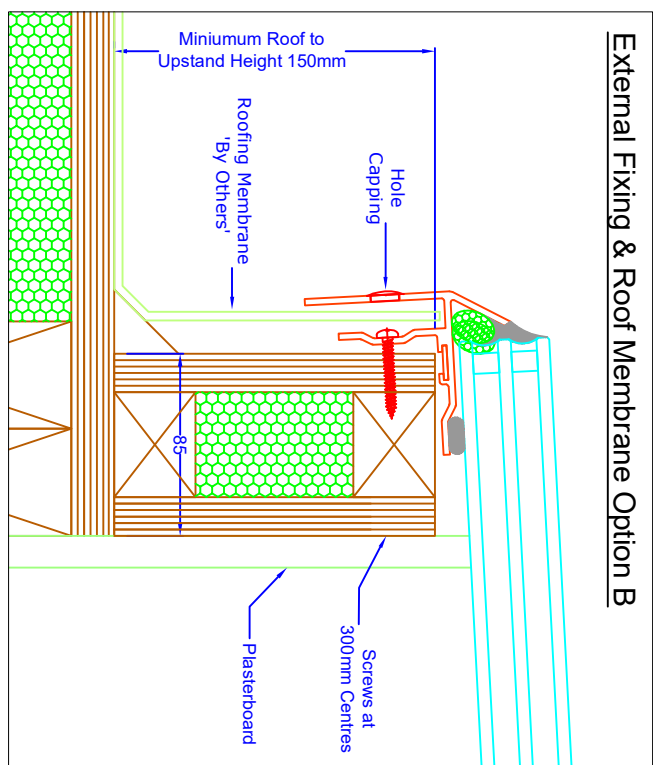

'In Kerb' External Trickle Vent Option

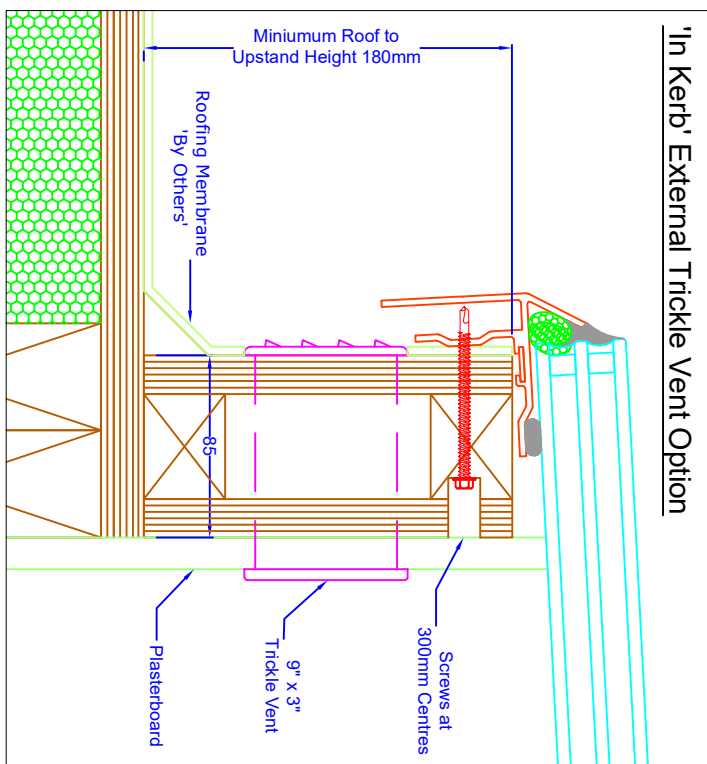

Internal Trickle Vent Option



Photo as Viewed from Outside

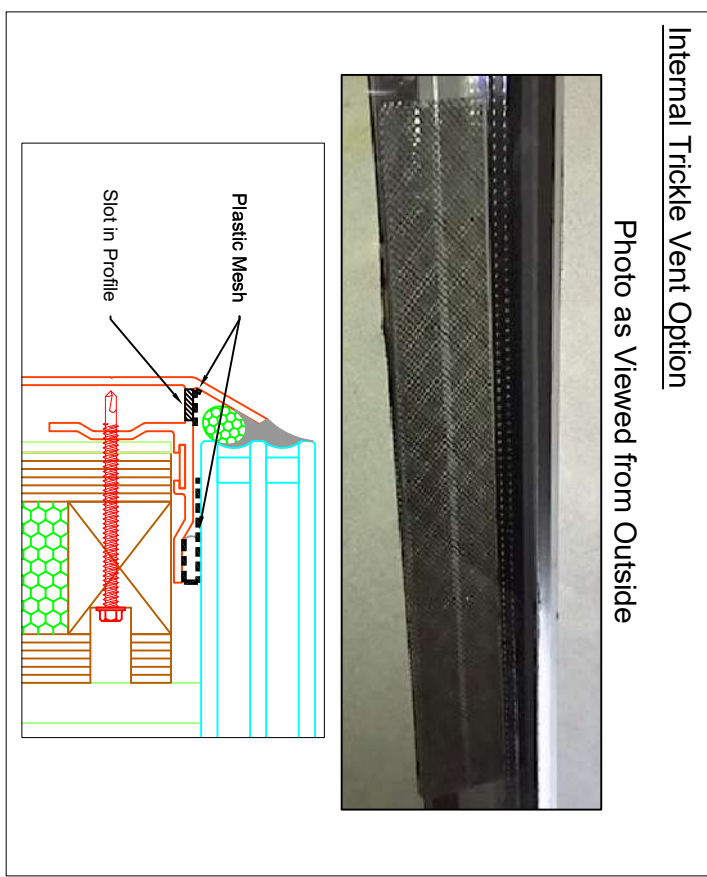

E			
D			
C	16/11/16	JW	Internal Trickle Vent Option Added
B	17/12/15	JW	Issued for Fabrication
A	17/12/15	JW	Notes
Rev	Date	Int.	Notes

Project AA Glazing System Slingglaze2			
The Triple Glazed Slingglaze2 Detail			
Scale	Date	Drawn By	Status
NTS	17/12/15	JW	
			Revision B



Registered Office: AA Glazing Systems Ltd, Unit 1 Mill Lane,
Waterford Ind Est, Gt. Massingham, Norfolk, PE32 2HT
Tel: 01485-520860 Fax: 01485-520861
Email: sales@aaaglazing.co.uk
Registered in England and Wales company no. 4346652
VAT No. 792 777 468